

SERIE K290A-15 Mecanizado de Aluminio

***PROMOCION PLATO + 20 PLACAS AXGT 15**

XK033 PLACA K290A AXGT 150508R KCN10



K290A-15 (Mirror polished)
K290A AXGT 1505..R KCN10

L = 24.4 ap = 15

Mango cilíndrico

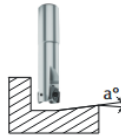
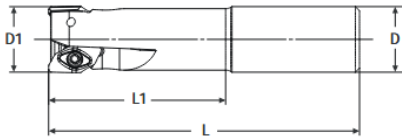

Tipo	Medidas (mm)						*PRECIO PROMOCION
	D1	D	L	L1	Z	a° max	
K290A EAL-D32-C32-160L-15	32	32	160	80	2	22.0	352 €
• K290A EAL-D40-C32-160L-15	40	32	160	50	2	16.0	357 €

- Bajo Pedido

Cabeza Roscada

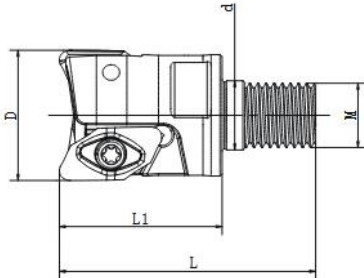

Tipo	Medidas (mm)						*PRECIO PROMOCION
	D	M	d	L	L1	Z	
K290A-2032-M16-15	32	M-16	17	63	42	2	352 €

Plato de arrastre

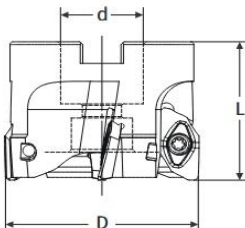

Tipo	Medidas (mm)					*PRECIO PROMOCION
	D	L	d	Z	a° max	
K290A FAL-D50-22-3T-15	50	45	22	3	10.0	367 €
K290A FAL-D63-27-4T-15	63	50	27	4	7.0	386 €

Promoción válida hasta el 30 de Noviembre de 2024

SERIE K290-10 Mecanizado de Aluminio

PROMO PLATO + 20 PLACAS AXGT 10

XK038 PLACA K290A AXGT 104308R KCN10

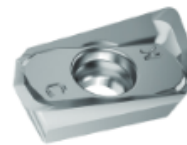

K290A-10 (Mirror polished)
K290A AXGT 1043..R KCN10

L= 12.48 ap = 10

Mango cilíndrico

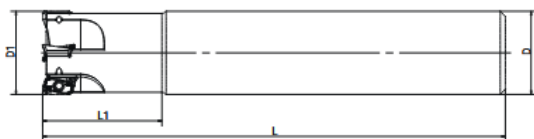

Tipo	Medidas (mm)					*PRECIO PROMOCION
	D1	D	L	L1	Z	
K290A 2016-C16-L120-10	16	16	120	25	2	173 €
K290A 3020-C20-L165-10	20	20	165	30	3	187 €
K290A 4025-C25-L180-10	25	25	180	35	4	200 €
K290A 5032-C32-L180-10	32	32	180	48	5	209 €

Cabeza Roscada

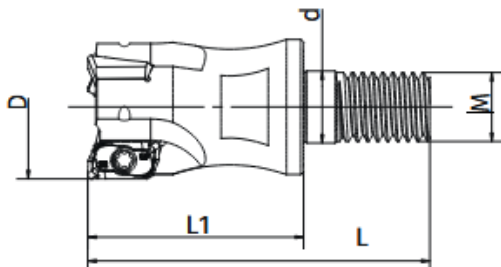

Tipo	Medidas (mm)						*PRECIO PROMOCION
	D	M	d	L	L1	Z	
K290A 2016-M8-10	16	M8	8.5	46	23	2	165 €
K290A 3020-M10-10	20	M10	10.5	49	30	3	173 €
K290A 3025-M12-10	25	M12	12.5	57	35	3	186 €
K290A 4032-M16-10	32	M16	17	63	43	5	200 €

Promoción válida hasta el 30 de Noviembre de 2024

PLACA K290A AXGT 15

CONDICIONES DE CORTE

ISO	Tipo de material	Dureza HB	Calidad	Velocidad de corte Vc (m/min)	Avance por diente fz (mm/t)
N	Aleación de Aluminio	60	KCN10	300-3000	0.15-0.35
			KCN10D	420-5000	0.15-0.45
		100	KCN10	200-2000	0.1-0.25
			KCN10D	280-2800	0.1-0.35
	Fundición de aluminio Aleada Si <12%	75	KCN10	200-2000	0.15-0.3
			KCN10D	280-2800	0.15-0.45
		90	KCN10	200-1500	0.1-0.25
			KCN10D	280-2100	0.1-0.35
	Fundición de Aluminio Si >12%	130	KCN10	200-1000	0.07-0.15
			KCN10D	280-1400	0.07-0.25
	Aleación de Cobre Pb >1%	110	KCN10	200-800	0.07-0.15
			KCN10D	280-1100	0.07-0.25
	Aleación de Cobre	90	KCN10	300-1000	0.1-0.15
			KCN10D	420-1400	0.1-0.35
		100	KCN10	300-800	0.1-0.15
			KCN10D	420-1100	0.1-0.3
Plásticos rígidos y reforzados con fibra	--	KCN10	100-500	0.1-0.15	
		KCN10D	140-700	0.1-0.3	
Ebonita	--	KCN10	100-300	0.1-0.15	
		KCN10D	140-420	0.1-0.3	

APLICACIONES

①

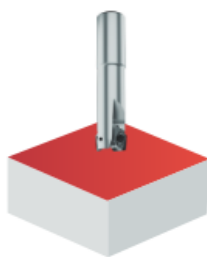

PLANEADO

②

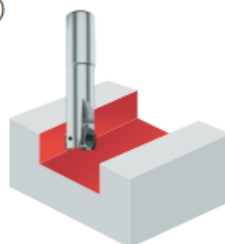

FRESADO EN PLUNGE

③

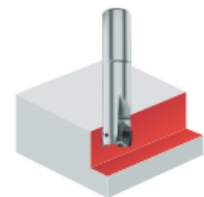

CONTORNEADO

④

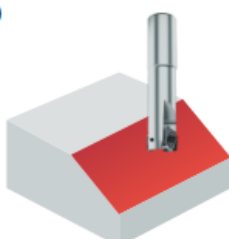

FRESADO EN RAMPA

⑤

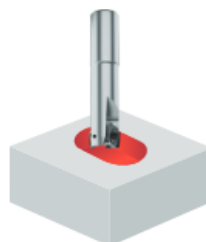

CAJEADO

PLACA K290A AXGT 10

CONDICIONES DE CORTE

Calidad	Velocidad de corte Vc (m/min)	Avance por diente fz (mm/t)	Profundidad de corte Ap (mm)
KCN10	300-1500	0.1-0.3	2-10
KCN10D	400-3000	0.2-0.4	2-10

APLICACIONES

①

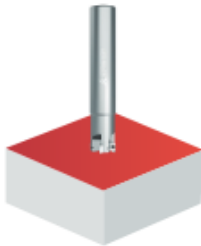

PLANEADO

②

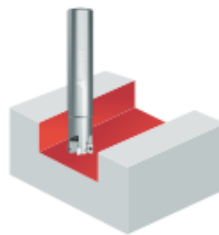

FRESADO EN PLUNGE

③

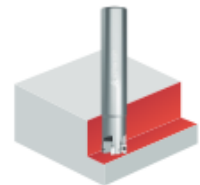

CONTORNEADO

④

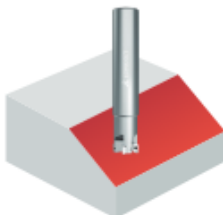

FRESADO EN RAMPA

⑤

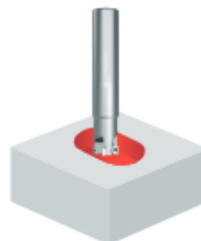

CAJEADO